

PUBLIC NOTICE

THE CITY OF SOUTHAMPTON (TOWNHILL PARK) ORDER 2019

NOTICE IS HEREBY GIVEN THAT SOUTHAMPTON CITY COUNCIL proposes to make the above Order, the effects of which would be:

1. To amend the no waiting at any time restrictions in **Meggesson Avenue** to apply as detailed below, to align with the new road layout:
 - (a) North-east side, From its junction with Townhill Way to 101m north-west of the north-western kerbline of Townhill Way, From 6m north-west of the extended north-western kerbline of Hazelwood Road to 47m south-east of the extended south-eastern kerbline of Wakefield Road, From 16m south-east of the extended south-eastern kerbline of Wakefield Road to 63m north-west of the north-western kerbline of Benhams Road, From 45m south-east of the south-eastern kerb-line of Cutbush Lane to 13m north-west of the north-western kerbline of Pond View, From 45m north-west of the north-western kerbline of Pond View north-westwards for 13m, From 77m north-west of the north-western kerbline of Pond View north-westwards for 19m, From 140m north-west of the north-western kerbline of Pond View north-westwards for 93m and From 81m south-east of the extended south-eastern kerbline of Pinefield Road to its junction with Forest Hills Drive.
 - (b) *South-west side*, From its junction with Townhill Way to 49m north-west of the north-western kerbline of Townhill Way, From 22m south-east of the south-eastern kerbline of Hazelwood Road to 15m north-west of the north-western kerbline of Hazelwood Road, From 98m north-west of the north-western kerbline of Hazelwood Road north-westwards for 82m, From 34m south-east of the south-eastern kerbline of Wakefield Road to 13m north-west of the north-western kerbline of Wakefield Road, From 50m north-west of the north-western kerbline of Wakefield Road north-westwards for 54m, From 30m south-east of the south-eastern kerbline of Ozier Road to 48.5m north-west of the north-western kerbline of Ozier Road, From 17m south-east of the south-eastern kerbline of Copse Road to 19.5m north-west of the north-western kerbline of Copse Road, and From 34m south-east of the south-eastern kerbline of Pinefield Road to 25m north-west of the north-western kerbline of Pinefield Road.

Copies of the draft Order, relevant map and statement of reasons for proposing may be inspected during normal working hours at Civic Centre, Southampton, SO14 7LY. Further information may also be obtained from the Highways division on 023 8079 8065.

Any person wishing to object to the Order must write to the Highways Legal Team at Southampton City Council, Civic Centre, Southampton, SO14 7LY or email Traffic.Orders.Legal@southampton.gov.uk quoting the Order Title you are objecting to and stating the grounds for objection, within 28 days of the date of this Notice (i.e. by 17th January 2020 – the consultation period has been extended from the standard 21 days to account for the christmas period).

Dated: 20th December 2019

Richard Ivory, Solicitor
Service Director, Legal and Governance
Southampton & Fareham Legal Services Partnership



PUBLIC NOTICE

THE CITY OF SOUTHAMPTON (VARIOUS ROADS) (SPEED LIMITS) (AMENDMENT 13) ORDER 2019

NOTICE IS HEREBY GIVEN THAT SOUTHAMPTON CITY COUNCIL proposes to make the above Order, the effects of which would be:

1. To introduce a 20mph speed limit on:
 - (a) **Cutbush Lane**, From its junction with Meggeson Avenue to its junction with Coachmans Copse,
 - (b) **Meggeson Avenue**, From 20m south-east of Wakefield Road to 12m north-west of Copse Road, and
 - (c) **Meggeson Avenue (Spur)**, for its entire length.

Copies of the draft Order, relevant map and statement of reasons for proposing may be inspected during normal working hours at Civic Centre, Southampton, SO14 7LY. Further information may also be obtained from the Highways division on 023 8079 8065.

Any person wishing to object to the Order must write to the Highways Legal Team at Southampton City Council, Civic Centre, Southampton, SO14 7LY or email Traffic.Orders.Legal@southampton.gov.uk quoting the Order Title you are objecting to and stating the grounds for objection, within 28 days of the date of this Notice (i.e. by 17th January 2020 – the consultation period has been extended from the standard 21 days to account for the christmas period).

Dated: 20th December 2019

Richard Ivory, Solicitor
Service Director, Legal and Governance
Southampton & Fareham Legal Services Partnership

PUBLIC NOTICE

THE CITY OF SOUTHAMPTON (TOWNHILL PARK) (CYCLE FACILITIES) NOTICE 2019

NOTICE IS HEREBY GIVEN THAT SOUTHAMPTON CITY COUNCIL in accordance with section 65 and section 66 of the Highways Act 1980 intends to construct the following cycle tracks:

LOCATION:	PERMITTED USE:
Meggeson Avenue Footways & Verges , <i>north-east side</i> , from 15m north-west of the north-western kerbline of Townhill Way to 5m south-east of the south-eastern kerbline of Benhams Road	on pedal cycles and on foot (shared use)

Copies of the relevant map may be inspected during normal working hours at Civic Centre, Southampton, SO14 7LY. Further information may also be obtained from the Highways division on 023 8079 8065.

Any person wishing to comment on this notice must write to the Highways Legal Team at Southampton City Council, Civic Centre, Southampton, SO14 7LY or email Traffic.Orders.Legal@southampton.gov.uk quoting the title of this notice, within 28 days of the date of this Notice (i.e. by 17th January 2020 – the consultation period has been extended from the standard 21 days to account for the Christmas period).

Dated: 20th December 2019

Richard Ivory, Solicitor
Service Director, Legal and Governance
Southampton & Fareham Legal Services
Partnership



PUBLIC NOTICE

THE CITY OF SOUTHAMPTON (TOWNHILL PARK) (ROAD HUMP) NOTICE 2019

NOTICE IS HEREBY GIVEN THAT SOUTHAMPTON CITY COUNCIL in accordance with Section 90A and 90C of the Highways Act 1980 and the Highways (Road Humps) Regulations 1999 intends to construct the following road humps:

LOCATION:	HEIGHT: (Millimetres)
Meggeson Avenue , From 61m north-west of the north-western kerbline of Townhill Way north-westwards for 3m (speed cushions)	100
Meggeson Avenue , From 96m north-west of the north-western kerbline of Townhill Way north-westwards for 43m & Hazelwood Road , From the south-western kerbline of Meggeson Avenue south-westwards for 12m (flat-top raised table)	100
Meggeson Avenue , From 29m north-west of the north-western kerbline of Hazelwood Avenue north-westwards for 3m (speed cushions)	100
Meggeson Avenue , From 116m north-west of the north-western kerbline of Hazelwood Avenue north-westwards for 3m (speed cushions)	100
Meggeson Avenue , From 60m south-east of the south-eastern kerbline of Wakefield Road south-eastwards for 3m (speed cushions)	100
Meggeson Avenue , From 17m south-east of the south-eastern kerbline of Wakefield Road to 56m north-west of the north-western kerbline of Wakefield Road & Wakefield Road , From the south-western kerbline of Meggeson Avenue south-westwards for 15m & Benhams Road , From the north-eastern kerbline of Meggeson Avenue north-eastwards for 10m (flat-top raised table)	100
Meggeson Avenue , From 88m north-west of the north-western kerbline of Wakefield Road north-westwards for 3m (speed cushions)	100
Meggeson Avenue , From 47m south-east of the south-eastern kerbline of Ozier Road south-eastwards for 3m (speed cushions)	100
Meggeson Avenue , From 18m south-east of the south-eastern kerbline of Ozier Road to 43m north-west of the north-western kerbline of Ozier Road & Ozier Road , From the south-western kerbline of Meggeson Avenue south-westwards for 9m & Cutbush Lane , From the north-eastern kerbline of Meggeson Avenue north-eastwards for 12m (flat-top raised table)	100
Meggeson Avenue , From 11m south-east of the south-eastern kerbline of Copse Road to 11m north-west of the north-western kerbline of Copse Road & Copse Road , From the south-western kerbline of Copse Road south-westwards for 11m (flat-top raised table)	100
Meggeson Avenue , From 81m north-west of the north-western kerbline of Copse Road north-westwards for 3m (speed cushions)	100
Meggeson Avenue , From 139m north-west of the north-western kerbline of Copse Road north-westwards for 3m (speed cushions)	100
Meggeson Avenue , From 206m north-west of the north-western kerbline of Copse Road north-westwards for 3m (speed cushions)	100
Meggeson Avenue , From 50m south-east of the south-eastern kerbline of Pinefield Road south-eastwards for 3m (speed cushions)	100
Ozier Road , From the north-eastern kerbline of Kingsdown Way northwards for 13m (flat-top raised table)	100

Copies of the relevant maps may be inspected during normal working hours at Civic Centre, Southampton, SO14 7LY. Further information may also be obtained from the Highways division on 023 8079 8065.

Any person wishing to object to these proposals must write to the Highways Legal Team at Southampton City Council, Civic Centre, Southampton, SO14 7LY or email Traffic.Orders.Legal@southampton.gov.uk quoting the title of this notice, within 28 days of the date of this Notice (i.e. by 17th January 2020 – the consultation period has been extended from the standard 21 days to account for the Christmas period).

Dated: 20th December 2019

Richard Ivory, Solicitor
Service Director, Legal and Governance
Southampton & Fareham Legal Services Partnership



PUBLIC NOTICE

THE CITY OF SOUTHAMPTON (TOWNHILL PARK) PEDESTRIAN CROSSING NOTICE 2019

NOTICE IS HEREBY GIVEN THAT SOUTHAMPTON CITY COUNCIL in accordance with Section 23 of the Road Traffic Regulation Act 1984 proposes to construct Zebra Crossings in the following locations:

1. **Meggeson Avenue**, 11m north-west of the north-western kerbline of Wakefield Road.
2. **Meggeson Avenue**, 11m south-east of the south-eastern kerbline of Ozier Road.

Copies of the relevant maps may be inspected during normal working hours at Civic Centre, Southampton, SO14 7LY. Further information may also be obtained from the Highways division on 023 8079 8065.

Any person wishing to object to the proposal must write to the Highways Legal Team at Southampton City Council, Civic Centre, Southampton, SO14 7LY or email Traffic.Orders.Legal@southampton.gov.uk quoting the title of this notice and stating the grounds for objection, within 28 days of the date of this notice (i.e. by 17th January 2020 – the consultation period has been extended from the standard 21 days to account for the christmas period).

Dated: 20th December 2019

Richard Ivory, Solicitor
Service Director, Legal and Governance
Southampton & Fareham Legal Services Partnership

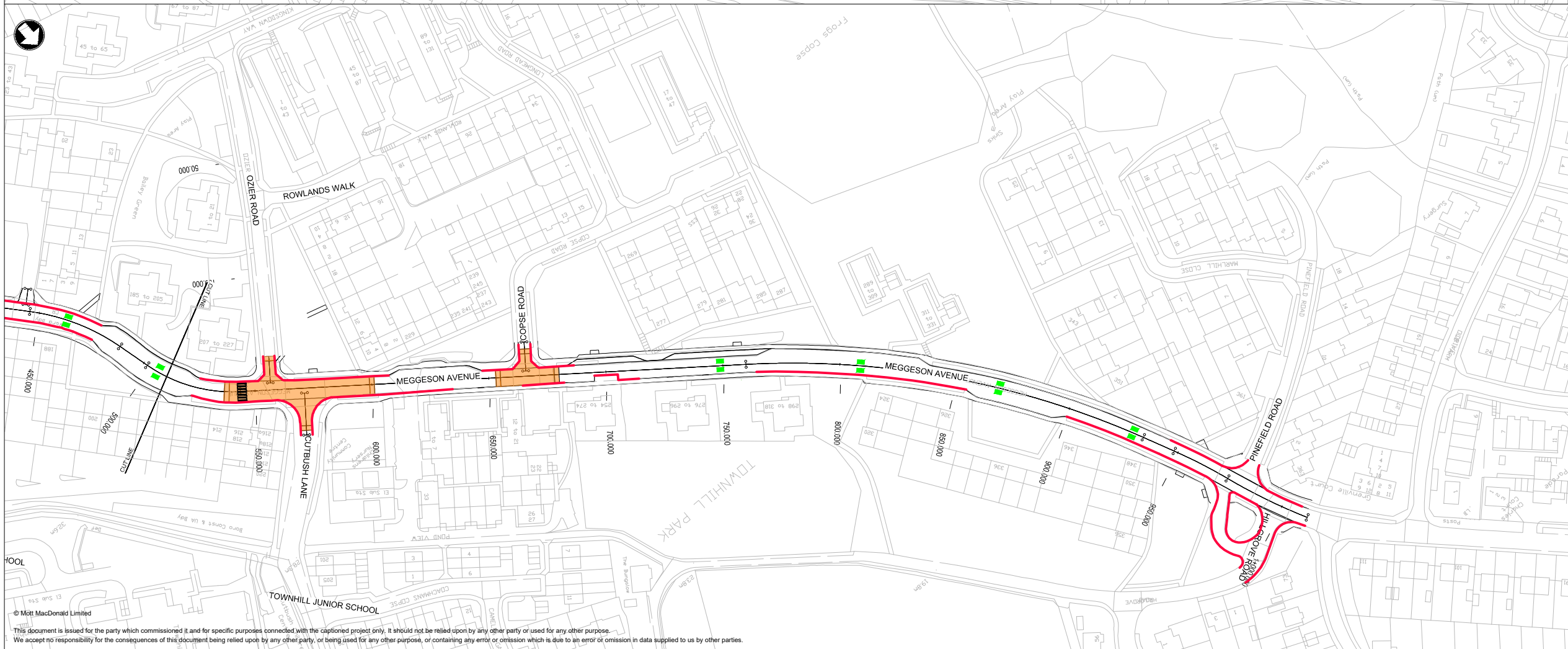
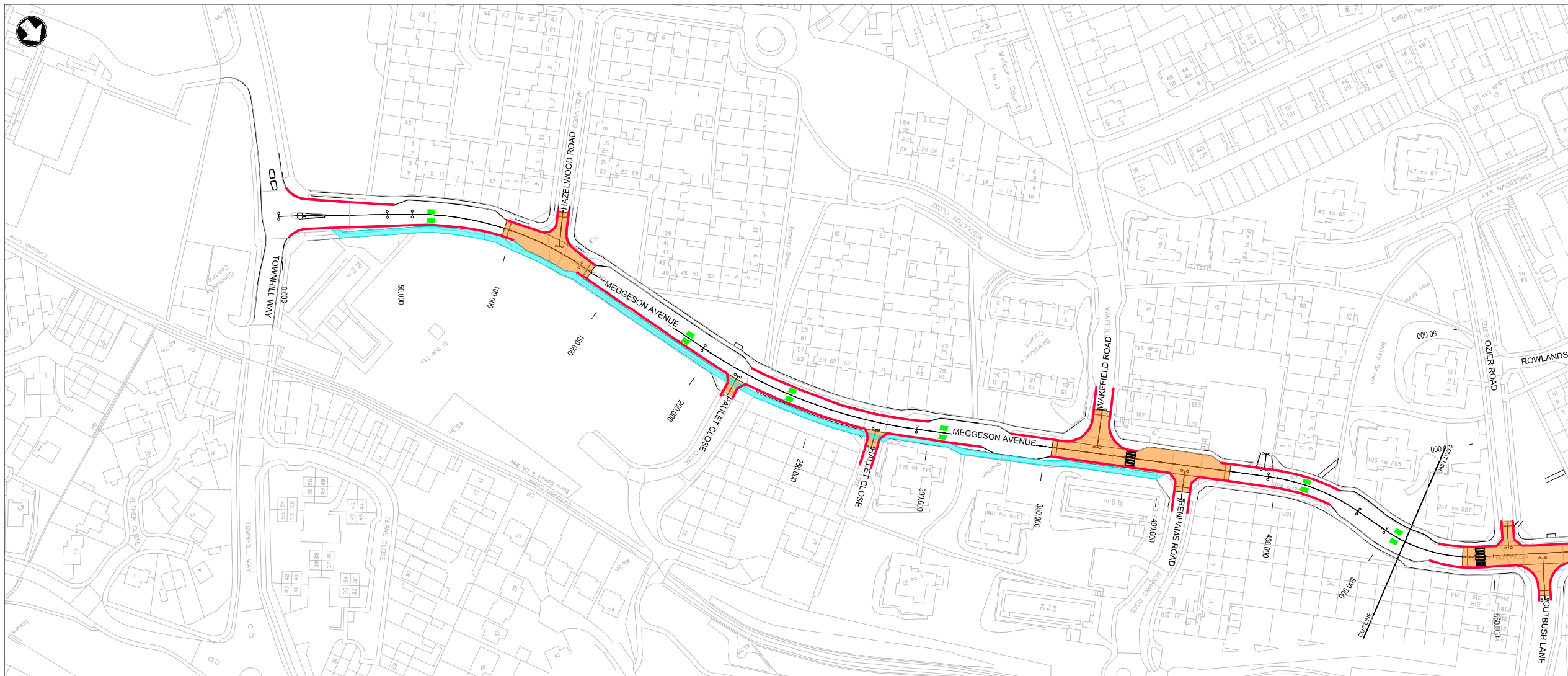

Notes

Key to symbols

- PROPOSED CONVERSION OF FOOTWAY TO SHARED USE CYCLE WAY/FOOTWAY.
- PROPOSED SPEED TABLE
- PROPOSED SPEED CUSHION
- NO WAITING AT ANY TIME RESTRICTION (NEW AND EXISTING)
- PROPOSED ZEBRA CROSSING

Reference drawings

Rev	Date	Drawn	Description	Ch'kd	App'd
P01	21/11/19	BG	FIRST REVISION	SM	FT
P02	13/12/19	BG	CHANGE TO YELLOW LINES	SM	SM
P03	17/12/19	BG	CHANGE TO THE KEY	SM	SM

Status Stamp

M
MOTT
MACDONALD

M

Balfour Beatty
Living Places

Client

Southampton City Council
Civil Centre
SOUTHAMPTON
SO14 7LY

Title

TOWNHILL PARK REGENERATION - TRAFFIC ROAD ORDER

Sheet 1 of 1

Designed	S.MARSLAND	SM	Eng check	S.J.MARSLAND	SM
Drawn	B.A.GOODMAN	BG	Coordination	S.J.MARSLAND	SM
Dwg check	D.NEW	DN	Approved	S.J.MARSLAND	SM
MMD Project Number	411112	Scale at A1	NTS	Security	STD
Suitability Description	Suitable for Stage Approval				Suit. Code
Drawing Number	411112-MMD-00-XX-DR-Z-1201				Revision
					P03

© Mott MacDonald Limited
 This document is issued for the party which commissioned it and for specific purposes connected with the captioned project only. It should not be relied upon by any other party or used for any other purpose.
 We accept no responsibility for the consequences of this document being relied upon by any other party, or being used for any other purpose, or containing any error or omission which is due to an error of omission in data supplied to us by other parties.

